

# Abiqua Landscape Products

## 503.873.3535

Best Wishes to all OHSET Athletes  
for a successful 2017 season

Sawdust  Shavings

**Delivery Available**

**We also carry these quality products**

**Cedar Hog Fuel . Woodchips . Compost**

**Fir Bark dust . Hemlock Bark dust**

**Topsoil . Soil mix . Sand . Crushed Rock**

**Round Rock . Pea Gravel**

**1295 N 1<sup>st</sup> St – Silverton**

**[www.abiqualandscapeproducts.com](http://www.abiqualandscapeproducts.com)**

## **24. In Hand Trail**

- 24.1. Required Equipment
  - 24.1.1. Halter and lead rope or leather lead
- 24.2. Prohibited Equipment
  - 24.2.1. Bridles of any type
  - 24.2.2. Whips, crops, or bats
  - 24.2.3. Spurs
  - 24.2.4. Chaps/Chinks
  - 24.2.5. Leg Wraps
  - 24.2.6. Ribbons, glitter, and sparkle on equine
- 24.3. Optional Equipment
  - 24.3.1. Headgear
    - 24.3.1.1. Western hat
    - 24.3.1.2. English helmet
    - 24.3.1.3. Regulation helmet
    - 24.3.1.4. No hat of any type
  - 24.3.2. Gloves
  - 24.3.3. Nose or chin chains
- 24.4. This class will use a regular trail course, with alterations to allow for animals to be shown in hand.
- 24.5. To be judged the same as a trail course.
- 24.6. After two refusals, the judge shall ask the athlete to move on to the next obstacle.
- 24.7. All obstacles (including bridges) are navigated by equine and handler.
- 24.8. Hand aids are allowed.
  - 24.8.1. Athletes may not touch equine unless directed by the judge or specified in the pattern.
  - 24.8.2. Athletes touching their equine should not expect a zero, but will be scored accordingly.
- 24.9. In Hand Trail equine is not restricted to size or breed.
- 24.10. Disqualifications *(Also see General Rules 8.0 Judging)*
  - 24.10.1. If an athlete enters the arena with missing required equipment, illegal equipment, or illegal use of permitted equipment, including uniform violations, not considered unsafe, the athlete will be allowed to continue on the course and receive scores and comments but will be disqualified from the event.
  - 24.10.2. Obvious lameness or unsoundness detected in participating equine will result in disqualification.

12/3/2016

2017

Date: \_\_\_\_\_

District: \_\_\_\_\_

CLASS: IN-HAND TRAIL

HIGH SCHOOL: \_\_\_\_\_

ATHLETE #: \_\_\_\_\_

#	ELEMENT JUDGED:	COMMENTS:	Score
1.	Be ready at start cone, position at gate for right hand push. Open, walk thru, close gate, position for turn		
2.	270° right haunch turn		
3.	Trot to end of box, halt, pick up hay net with left hand		
4.	Trot over poles to brush box		
5.	Walk thru brush box, halt, place hay net on barrel		
6.	Step out of brush box, trot to right end of sidepass		
7.	Sidepass left		
8.	Trot around cones and over pole, stop, change sides, sidepass right		
9.	180° left forehand turn		
10.	Trot into 'L' as diagramed, back 'L'		
11.	Sidepass right, walk over bridge, wait to be excused		
12.	Overall Horsemanship		

Judge's Signature: \_\_\_\_\_

**Expectations:**

- Athlete and equine should create a working team. Movement through and over obstacles should be crisp while allowing the equine to negotiate each step. Accuracy, smoothness, and acceptance of obstacles should be points of training. Timing will count.
- Handlers should perform all obstacles with horse unless specifically noted.
- Haunch turns, pivots, lateral movements and backing should be smooth with continual movement.
- Refusals will deduct points. After 2 unsuccessful attempts, handlers will be asked to move on. A refusal is any unnecessary and unintentional movement not aiding in completion of the maneuver. The following two examples would be considered refusals. A horse taking a step backwards while approaching a bridge without being asked to do so by its handler. A horse taking a step forward while attempting to complete back through without being asked to do so by its handler. An unintentional complete stop of movement while approaching or completing an obstacle will also be considered a refusal.
- It should appear that the equine is working without the use of a lead rope exhibiting no resistance.
- Judges will be looking for "finished" equine/athlete team.

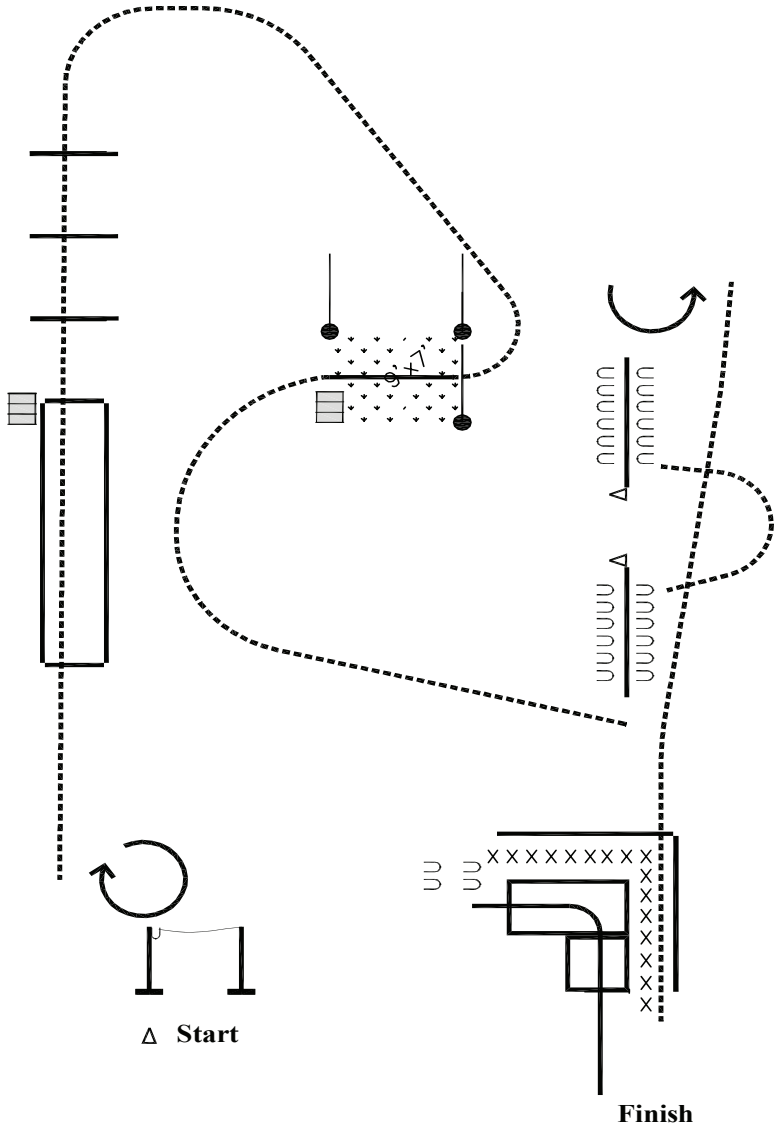

**OHSET**  
**2016-2017**  
**In Hand Trail**  
 Revised 12-03-16

Legend :	
Walk	—————
Jog/Trot	- - - - -
Back	XXXXXXXXXX
Sidepass	UUUUUU
Start Cone	△

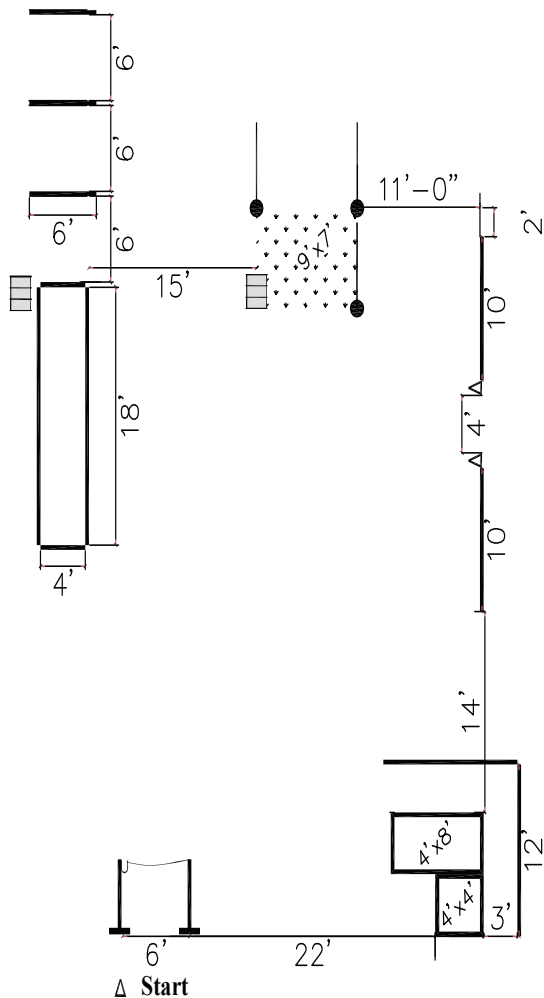

**OHSET**  
 2016-2017  
 In Hand Trail Dimensions  
 Revised 12-03-16

Equipment Needed:
(1) Bridge 4'x8' (min 4'x6')
(1) Bridge 4'x4'
(2) 12' poles
(4) 10' poles
(2) 8' poles
(3) 6' poles
(2) 4' poles
(2) barrels
(3) gaming poles
(1) rope gate (approx. 6')
(1) loose brush, enough to fill 9'x7' area
(1) hay net
(3) standard cones (about 12"-18" tall)